

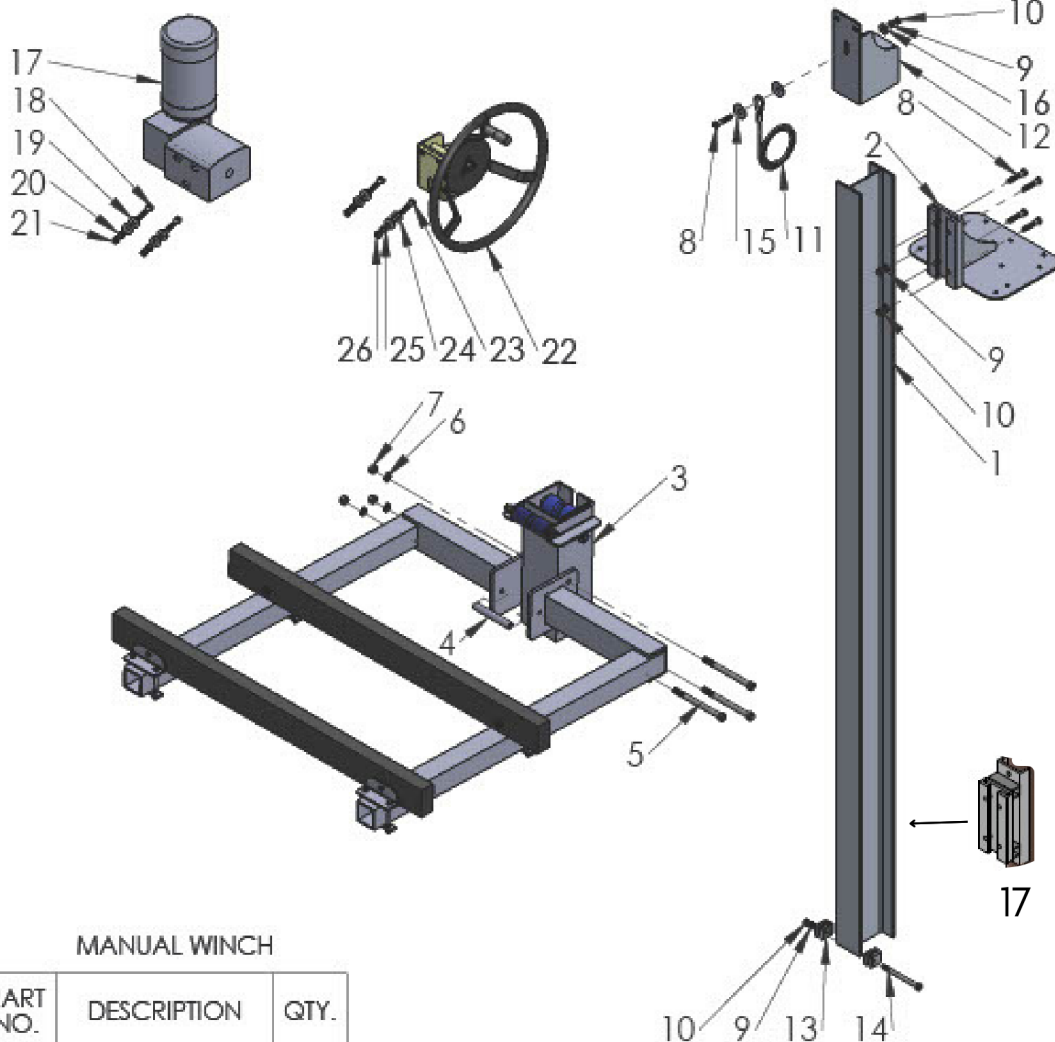

BOAT LIFT WAREHOUSE PWC LIFT

EXPLODED ASSEMBLY VIEW

PART NO.	DESCRIPTION	QTY.
1	TRACK	1
2	DOCK MOUNT	1
3	HOUSING	1
4	6" SPACER	1
5	5/8"-11 X 8" SS BOLT	3
6	5/8" SS LOCKWASHER	3
7	5/8"-11 SS NUT	3
8	1/2"-13 X 2.5" SS BOLT	7
9	1/2" SS LOCKWASHER	8
10	1/2"-13 NUT	8
11	1/4" SS CABLE	1
12	DRIVE MOUNT	1
13	STOP BLOCK	2
14	1/2"-13 X 6" SS BOLT	1
15	1/2" CABLE WASHER	2
16	1/2" FLATWASHER	5
17	Pile Mount Bracket	1



ELECTRIC WINCH

PART NO.	DESCRIPTION	QTY.
17	ELECTRIC WINCH	1
18	1/2"-13 X 2.5" SS BOLT	2
19	1/2" SS FLATWASHER	4
20	1/2" SS LOCKWASHER	2
21	1/2"-13 NUT	2

MANUAL WINCH

PART NO.	DESCRIPTION	QTY.
22	MANUAL WINCH	1
23	3/8"-16 X 1.5" SS BOLTS	2
24	3/8" SS FLATWASHER	4
25	3/8" SS LOCKWASHER	2
26	3/8"-16 SS NUT	2

PAGE 1

"OUTLASTING THE ELEMENTS!"

877-GOT-LIFT
boatliftwarehouse.com



EXPLODED CARRIAGE ASSEMBLY

PART NO.	DESCRIPTION	QTY.
26	CRADLE ARMS	2
27	BUNK BOARDS	2
28	3/8"-13 X 3" SS BOLT	4
29	3/8" SS FLATWASHER	4
30	3/8"-16 SS NUT	12
31	3/8" SS LOCKWASHER	12
32	TOP BUNK BRACKET	4
33	BOTTOM BUNK BRACKET	4
34	3/8"-16 X 4" SS BOLT	8

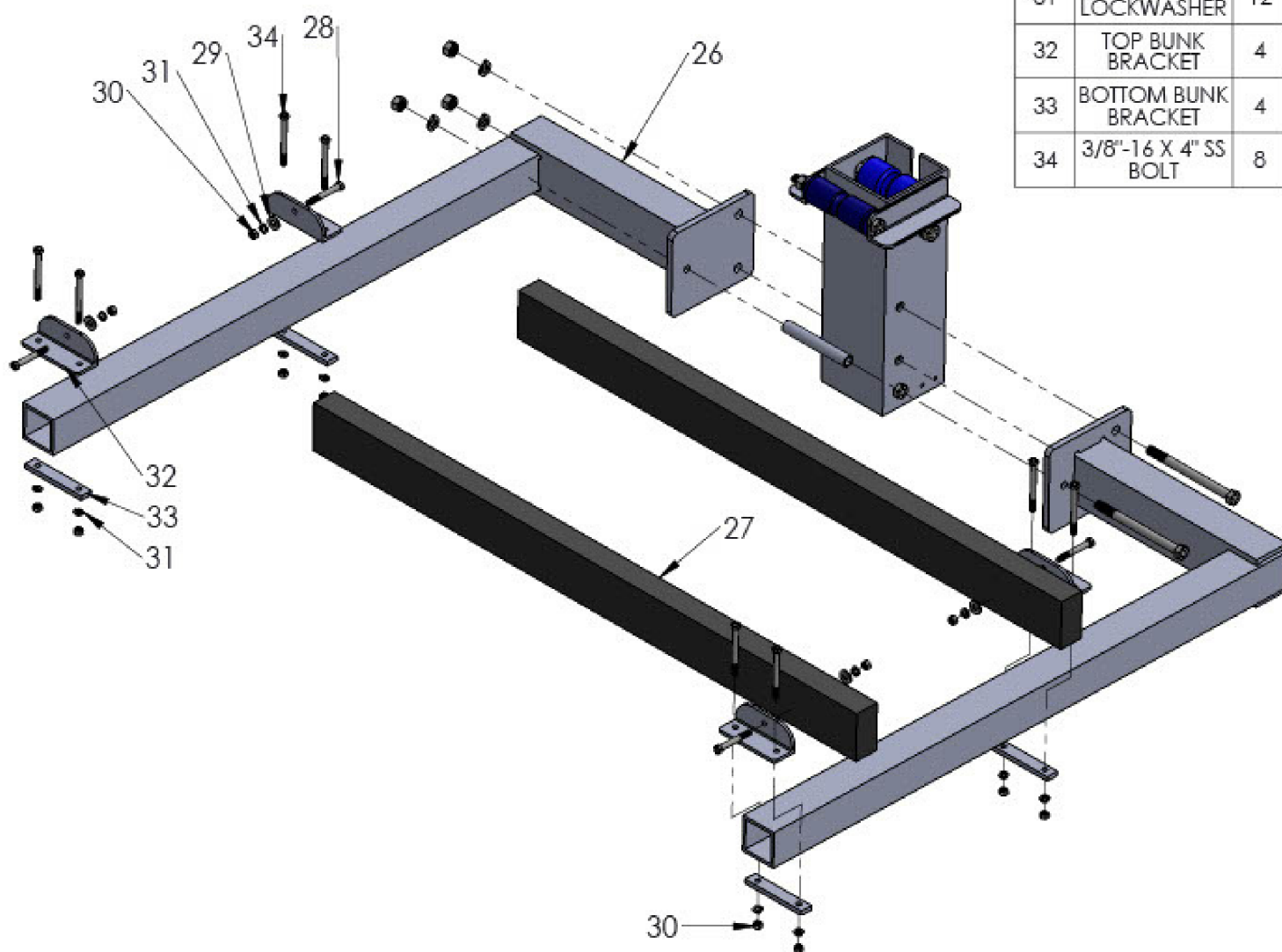

PAGE 2

"OUTLASTING THE ELEMENTS!"

877-GOT-LIFT
boatliftwarehouse.com



DOCK MOUNT INSTALLATION

PART NO.	MFG. NO.	DESCRIPTION	QTY.
1	W-0107	DOCK MOUNT	1

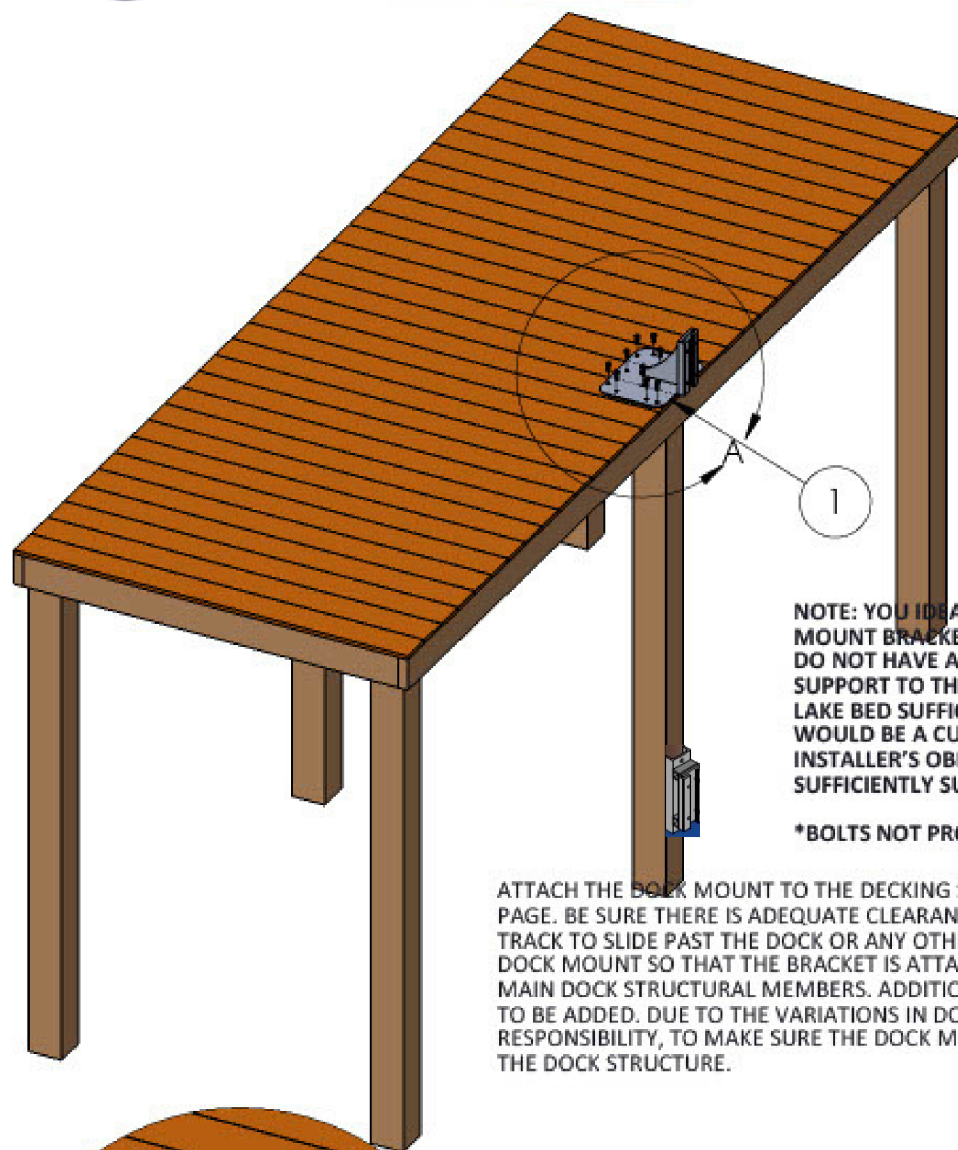

BOLTS ARE 1/2" DIAMETER THE LENGTH IS CONIENGENT ON THE DOCK DESIGN.

NOTE: YOU IDEALLY WANT TO MOUNT YOUR DOCK MOUNT BRACKET IN FRONT OF A POST OR PILING. IF YOU DO NOT HAVE A PILING YOU SHOULD ADD ADEQUATE SUPPORT TO THE TRACK OR DRIVE THE I-BEAM INTO THE LAKE BED SUFFICIENTLY TO SUPPORT THE WEIGHT. THIS WOULD BE A CUSTOM INSTALL AND WOULD BE THE INSTALLER'S OBLIGATION TO MAKE SURE THE TRACK IS SUFFICIENTLY SUPPORTED.

BOLTS NOT PROVIDED

ATTACH THE DOCK MOUNT TO THE DECKING SURFACE AS ILLUSTRATED ON THIS PAGE. BE SURE THERE IS ADEQUATE CLEARANCE AS SHOW IN "DETAIL B" FOR THE TRACK TO SLIDE PAST THE DOCK OR ANY OTHER OBSTRUCTIONS. MOUNT THE DOCK MOUNT SO THAT THE BRACKET IS ATTACHED SECURELY TO THE DOCKS MAIN DOCK STRUCTURAL MEMBERS. ADDITIONAL DOCK SUPPORTS MAY NEED TO BE ADDED. DUE TO THE VARIATIONS IN DOCK DESIGN, IT IS THE INSTALLER'S RESPONSIBILITY, TO MAKE SURE THE DOCK MOUNT IS SECURED SUFFICIENTLY TO THE DOCK STRUCTURE.

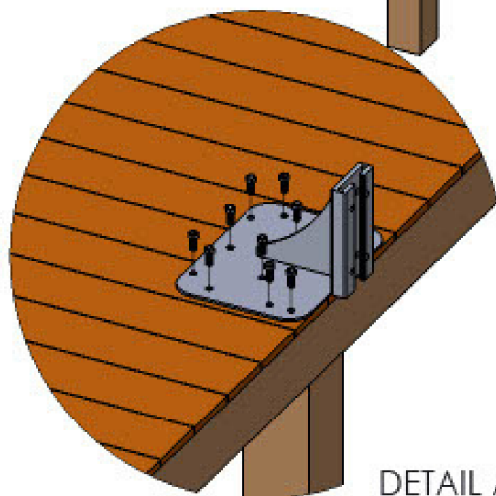

DETAIL A

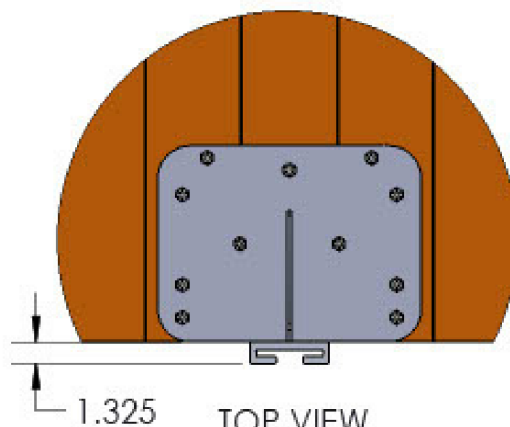

1.325

TOP VIEW



STOP BLOCK INSTALLATION (1)

PART NO.	MFG. NO.	DESCRIPTION	QTY.
1	0563	TRACK	1
2	0590	STOP BLOCK	2
3		1/2"-13 x 6" SS BOLT	1
4		1/2" SS LOCKWASHER	1
5		1/2"-13 SS NUT	1

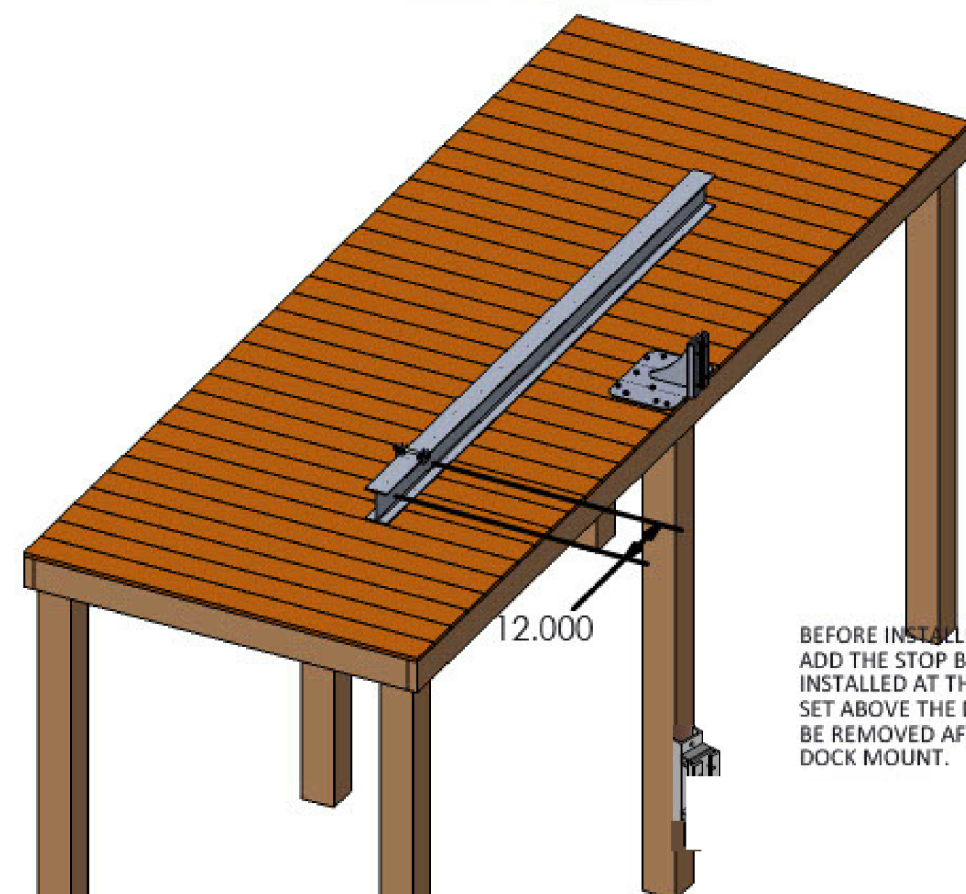

BEFORE INSTALLING THE TRACK IN THE DOCK MOUNT ADD THE STOP BLOCKS TO THE MAST. THIS SHOULD BE INSTALLED AT THE LEVEL YOU DESIRE YOUR HOIST TO SET ABOVE THE DOCK SURFACE. THE STOP BLOCKS WILL BE REMOVED AFTER THE MAST IS SECURED TO THE DOCK MOUNT.

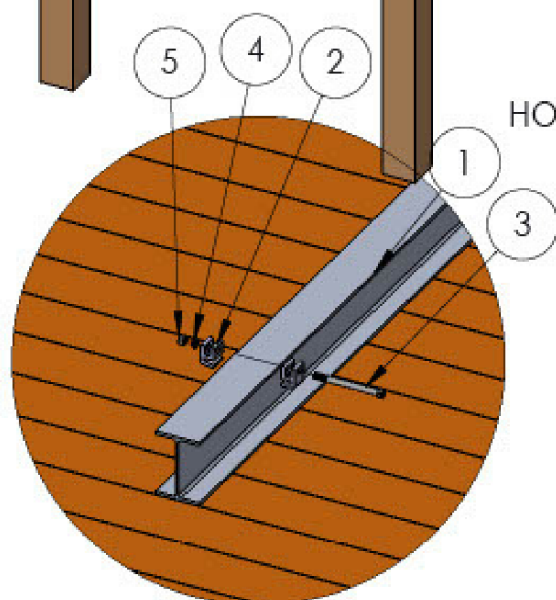

HOIST SHOWN FOR REFERENCE

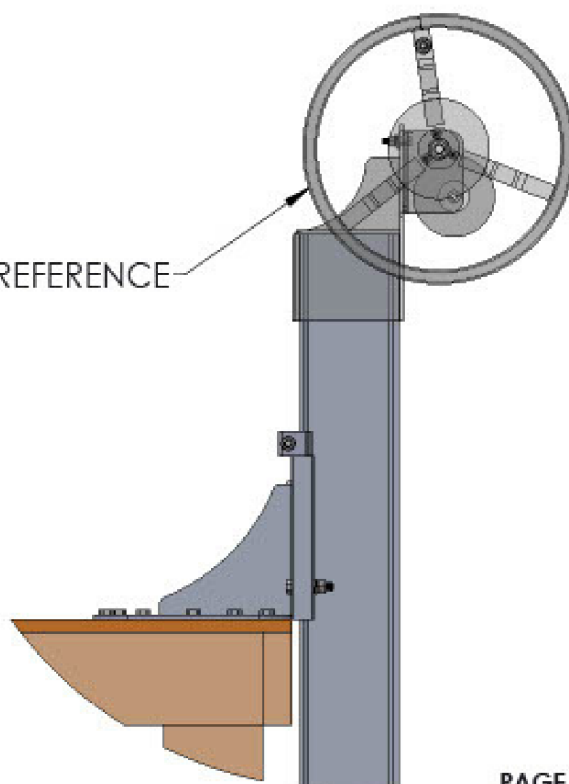

PAGE 4



TRACK INSTALLATION

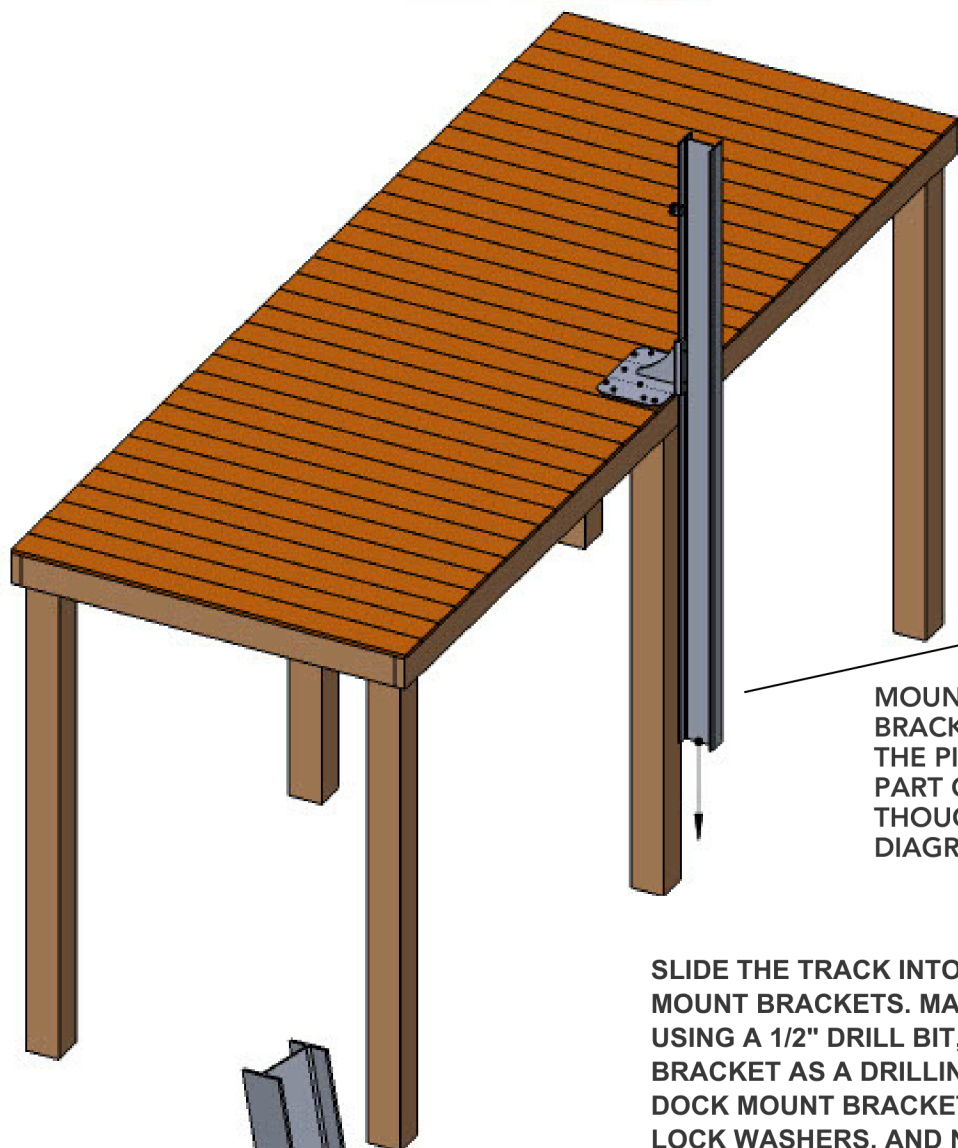

PART NO.	MFG. NO.	DESCRIPTION	QTY.
1		1/2"-13 X 2.5" SS BOLT	4
2		1/2" SS LOCKWASHER	4
3		1/2"-13 SS NUT	4

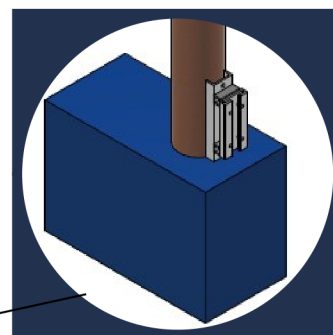

MOUNT THE LOWER PILING MOUNT BRACKET AT THE WATERLINE. NOTE THAT THE PILING MOUNT BRACKET IS A CRITICAL PART OF THE INSTALLATION PROCESS, EVEN THOUGH IT IS NOT SHOWN IN ALL DIAGRAMS.

SLIDE THE TRACK INTO THE DOCK MOUNT AND PILING MOUNT BRACKETS. MAKE SURE THE TRACK IS PLUMB. USING A 1/2" DRILL BIT, DRILL THE TRACK USING THE BRACKET AS A DRILLING JIG. BOLT THE TRACK TO THE DOCK MOUNT BRACKET USING THE 1/2" X 2 1/2" BOLTS, LOCK WASHERS, AND NUTS PROVIDED. LAST REMOVE THE STOP BLOCKS.

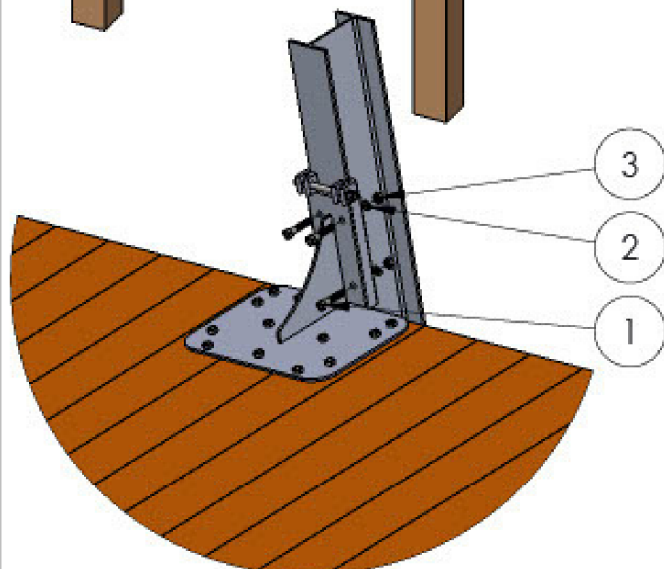



STOP BLOCKS INSTALLATION (2)

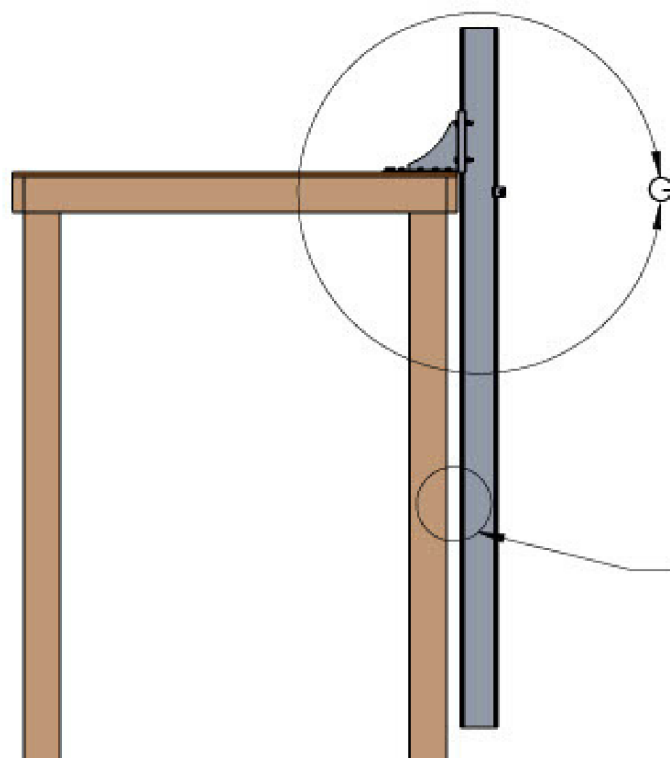

REINSTALL THE STOP BLOCK ON THE FRONT SIDE OF THE TRACK 32" FROM THE TOP OF THE TRACK. **SEE DETAIL "G"**

DUE TO VARRIATIONS IN DOCK DESIGNS WOOD SHIMS MAY NEED TO BE ADDED BEHIND THE TRACK TO FILL ANY GAPS.

(NOT PROVIDED)

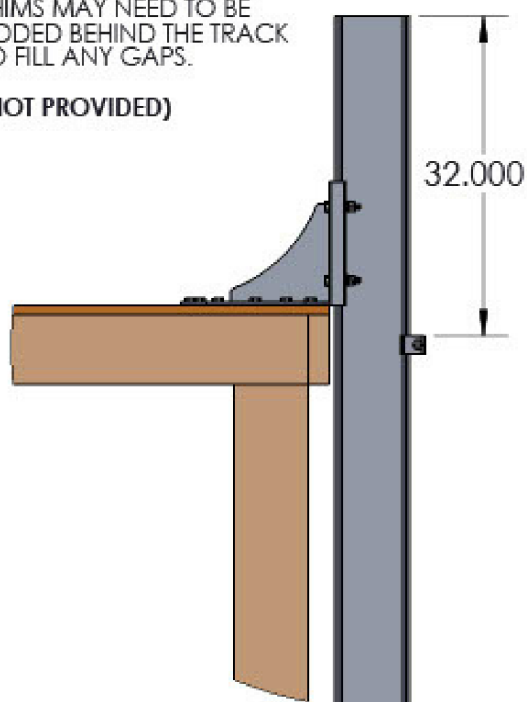
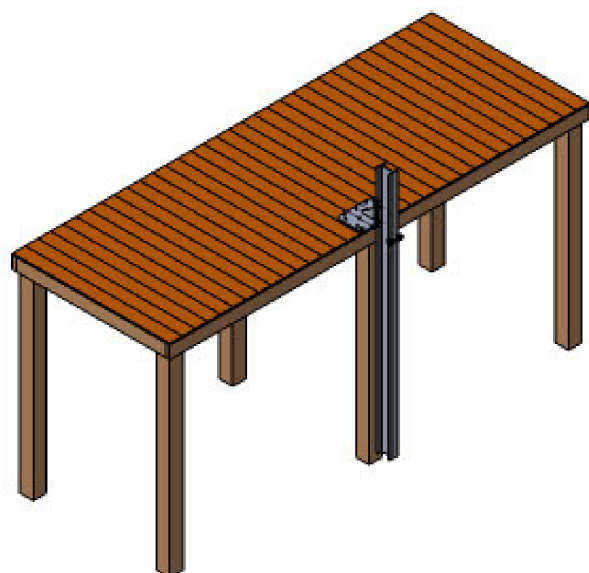

DETAIL G



HOUSING, ARM & BUNK BOARD ASSEMBLY

ARMS: ATTACH THE ARMS TO THE HOUSING USING THE 5/8" X 8" BOLTS, LOCKS, AND NUTS PROVIDED. DO NOT OVER TIGHTEN. OVER TIGHTENING THESE BOLT WILL CAUSE THE HOUSING TO COMPRESS, AND MISALIGN THE ROLLERS. USING THE SPACER AND 5/8" X 8" BOLTS CONNECT THE ARMS TOGETHER IN FRONT OF THE HOUSING. THIS KEEPS YOUR ARMS SQUARE DURING THE LIFTING PROCESS.

PART NO.	MFG. NO.	DESCRIPTION	QTY.
1	AB-0007.3	1500 ARM WELDMENT	2
2	0589	6" SPACER	1
3		5/8"-11 X 8" SS BOLT	3
4		5/8" SS LOCKWASHER	3
5		5/8"-11 SS NUT	3

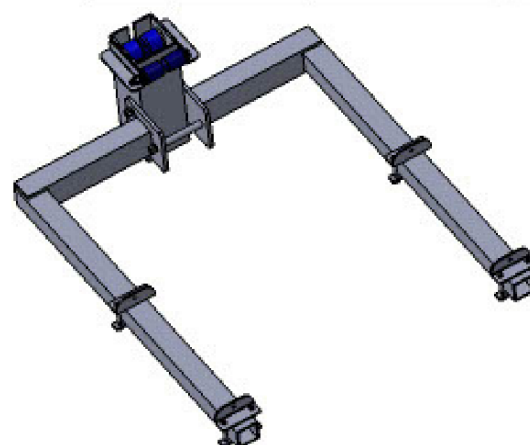
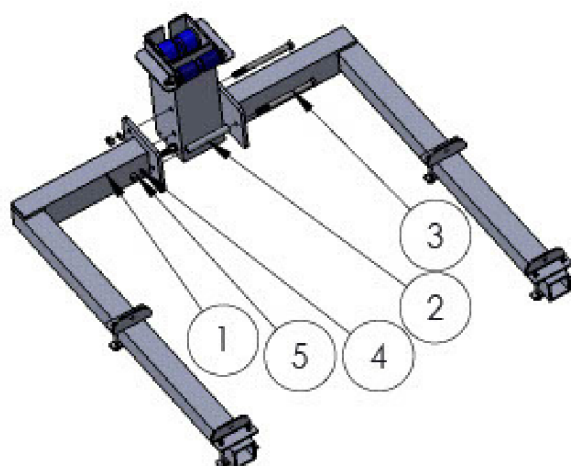

BUNK BOARDS: ATTACH THE BUNK BOARD BRACKETS USING THE 3/8" X 4" BOLTS, AND BOTTOM PLATES. ATTACH THE BUNK BOARDS TO THE BUNK BRACKETS USING THE 3/8" X 3" BOLTS, LOCKS, AND NUTS PROVIDED. THE BUNK BOARDS ARE ADJUSTABLE TO ACCOMMODATE YOUR VESSELS HULL CONFIGURATION. THIS IS THE INSTALLER'S RESPONSIBILITY TO ADJUST THE BUNK BOARDS PROPERLY TO FIT THE VESSEL.

THIS ASSEMBLY IS CALLED THE CARRIAGE ASSEMBLY FROM HERE FORWARD.

PART NO.	MFG. NO.	DESCRIPTION	QTY.
1	0585	BUNK BOARD	2
2		3/8"-16 X 3" SS BOLT	4
3		3/8" SS FLATWASHER	4
4		3/8" SS LOCKWASHER	4
5		3/8"-16 SS NUT	4

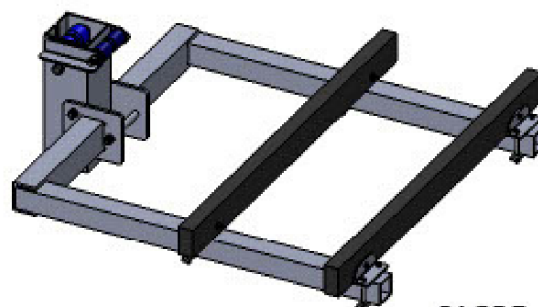
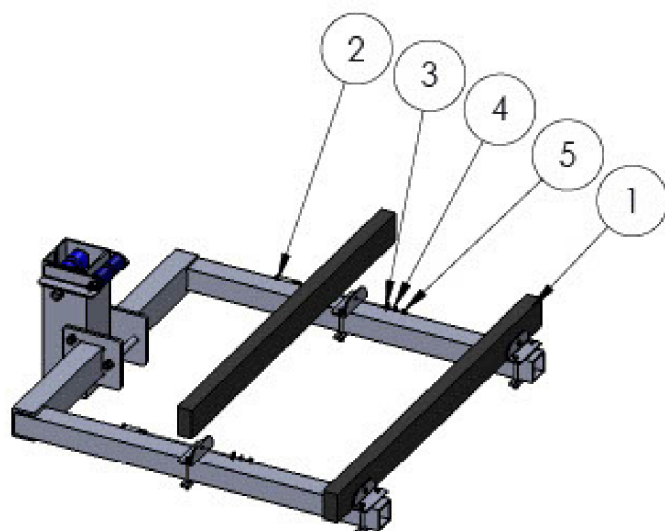

PAGE 7

"OUTLASTING THE ELEMENTS!"

877-GOT-LIFT
boatliftwarehouse.com



CARRIAGE INSTALLATION

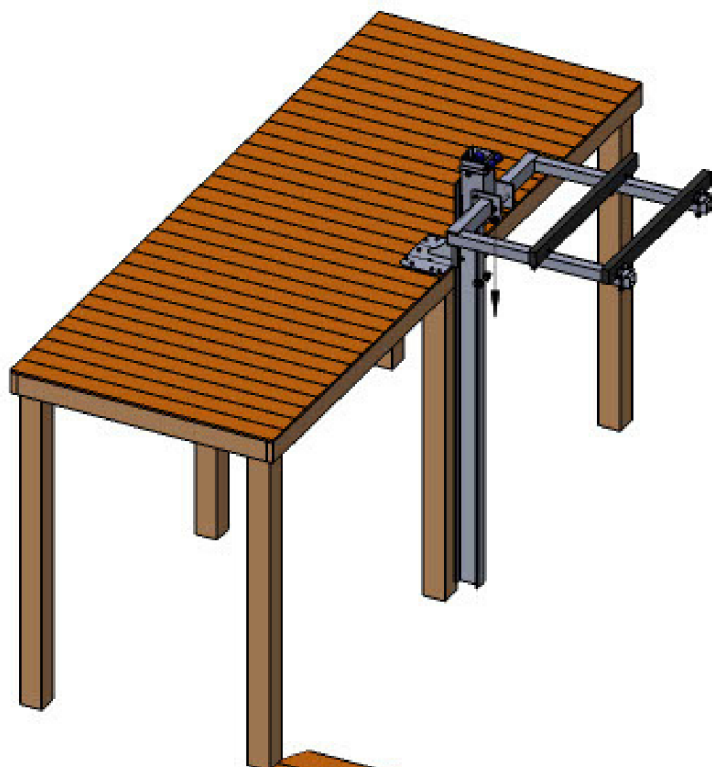

INSTALL THE CARRIAGE ASSEMBLY BY SLIDING THE CARRIAGE ASSEMBLY OVER THE TRACK. THE STOP BLOCK ASSEMBLY WILL PREVENT THE CARRIAGE FROM DROPPING INTO THE WATER DURING INSTALLATION.

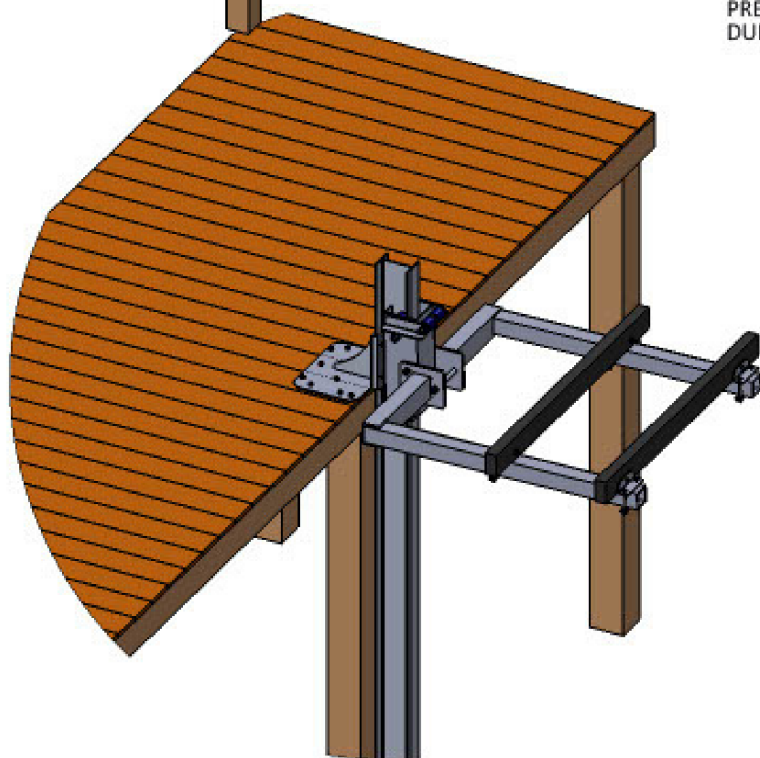



MANUAL HOIST ASSEMBLY

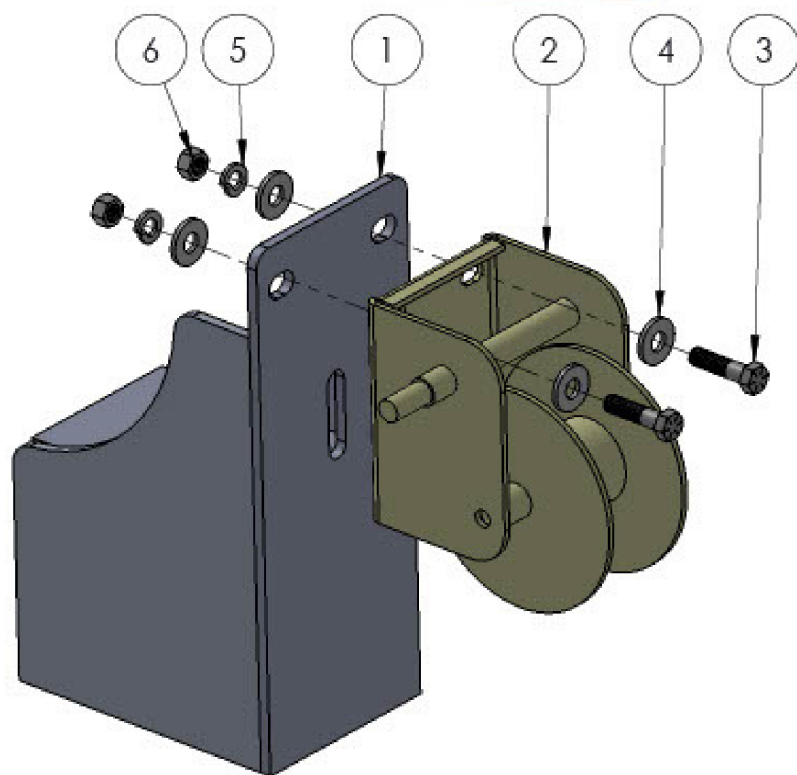

PART NO.	MFG. NO.	DESCRIPTION	QTY.
1	W-0108	MOTOR MOUNT	1
2		MANUAL HOIST	1
3		3/8"-16 X 1.5" SS BOLT	2
4		3/8" SS FLATWASHER	4
5		3/8" SS LOCKWASHER	2
6		3/8"-16 SS NUT	2
7	A-0188	HAND CRANCK WHEEL	1
8		SPRING	1
9		1/2"-13 SS NUT	1

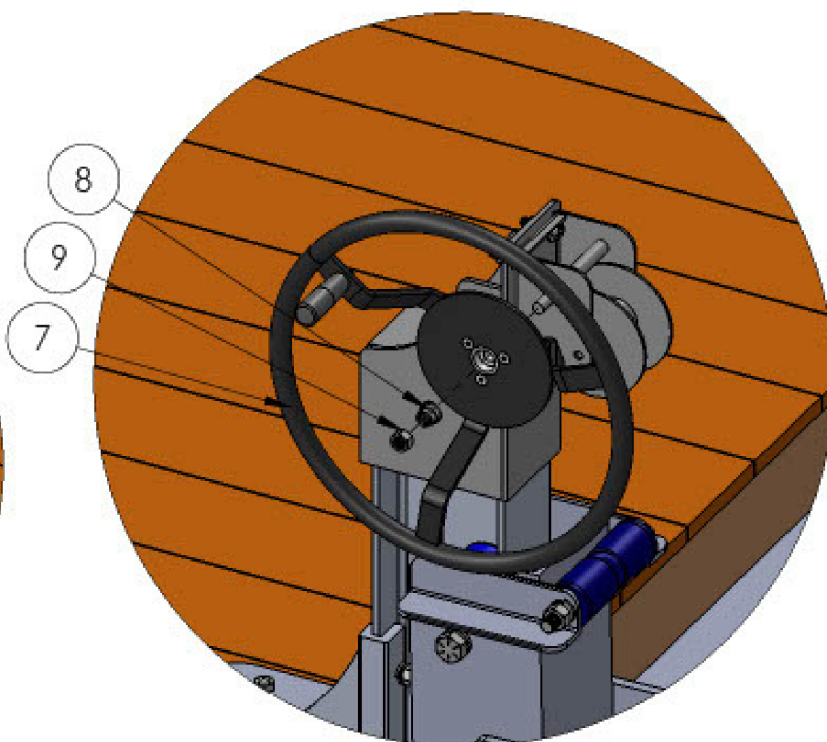
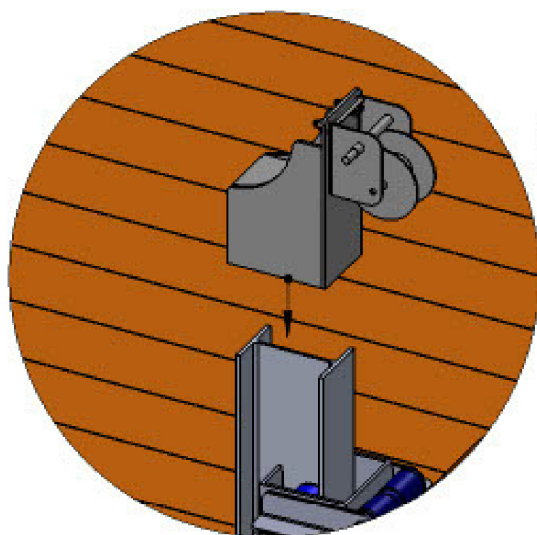

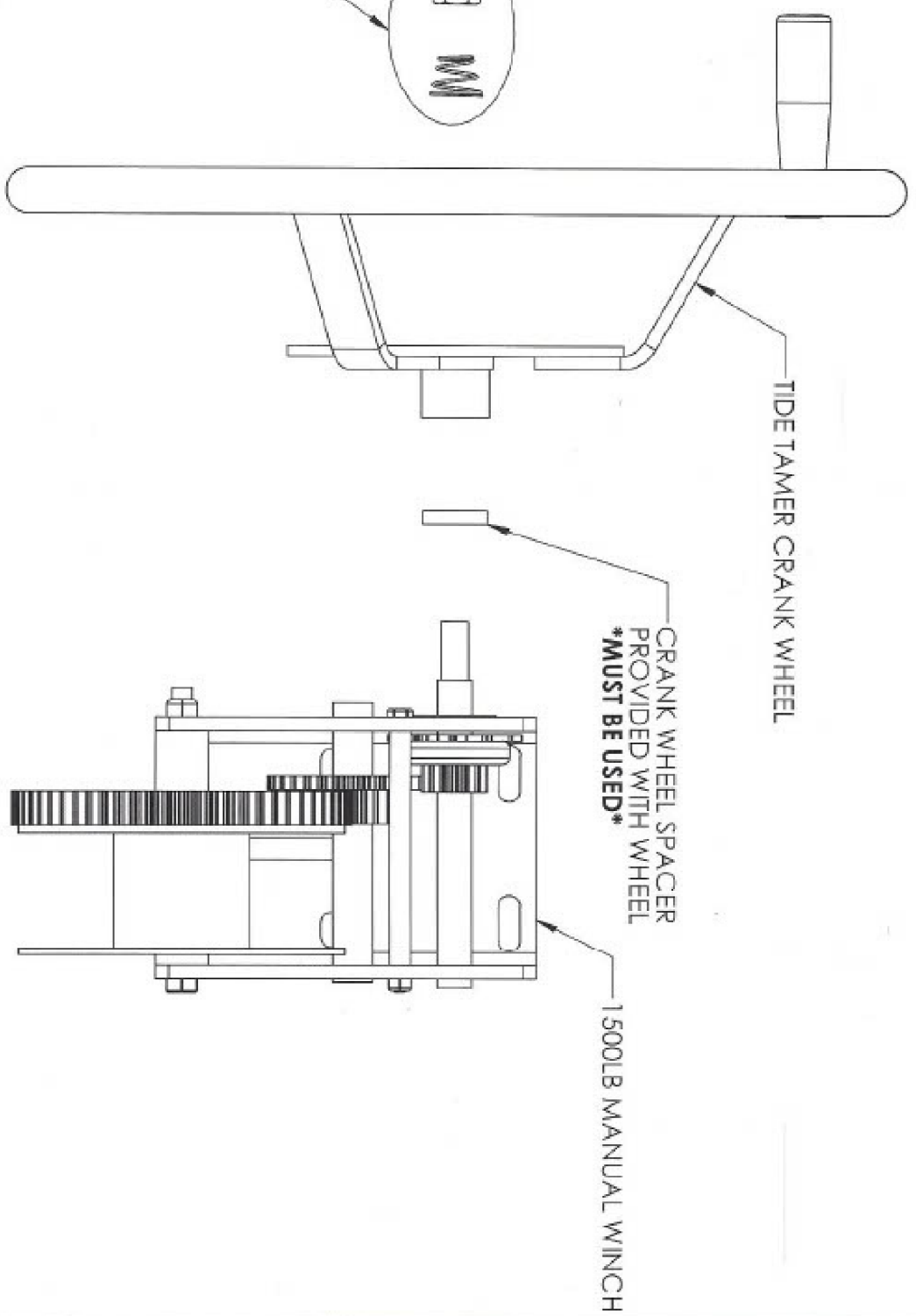

HAND CRANK
MOUNT HARDWARE
PROVIDED IN BOX
WITH WINCH

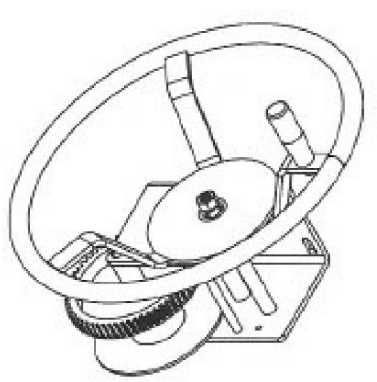

PH: 800-325-1116
FAX: 252-747-4377
TIDE TAMER.COM
P.O. BOX 1118
SNOW HILL, NC 28580

NAME	DATE
ACC	5-7-19
CHECKED	
ENG. APPR.	

COMMENTS:

TITLE:
**BLW PWC LIFT CRANK
WHEEL INSTALLATION**

SIZE DWG. NO. REV
A **INSTALL**

PROPRIETARY AND CONFIDENTIAL
THE INFORMATION CONTAINED IN THIS
DRAWING IS THE SOLE PROPERTY OF
TIDE TAMER INDUSTRIES. ANY
REPRODUCTION IN PART OR AS A WHOLE
WITHOUT THE WRITTEN PERMISSION OF
TIDE TAMER INDUSTRIES IS PROHIBITED.

UNLESS OTHERWISE SPECIFIED:
DIMENSIONS ARE IN INCHES
TOLERANCES:
FRACTIONAL: ±
DECIMAL: ±
THREE PLACE DECIMAL: ±
DO NOT SCALE DRAWING

SCALE: AS NOTED SHEET 1 OF 1



ELECTRIC HOIST ASSEMBLY

PART NO.	MFG. NO.	DESCRIPTION	QTY.
1	W-0108	MOTOR MOUNT	1
2		ELECTRIC HOIST	1
3		1/2"-13 X 2.5" SS BOLT	2
4		1/2" SS FLATWASHER	4
5		1/2" SS LOCKWASHER	2
6		1/2"-13 SS NUT	2

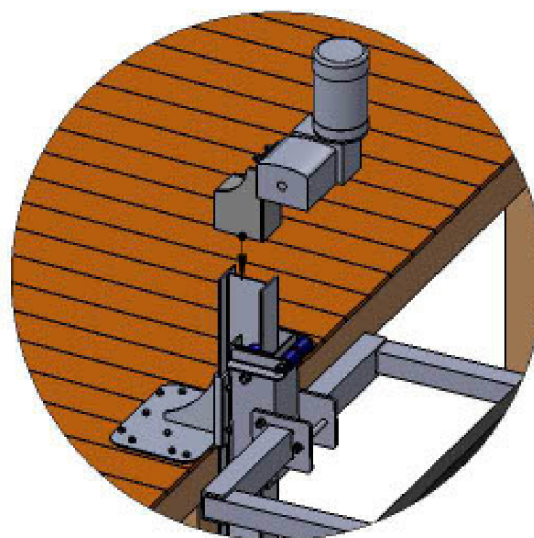
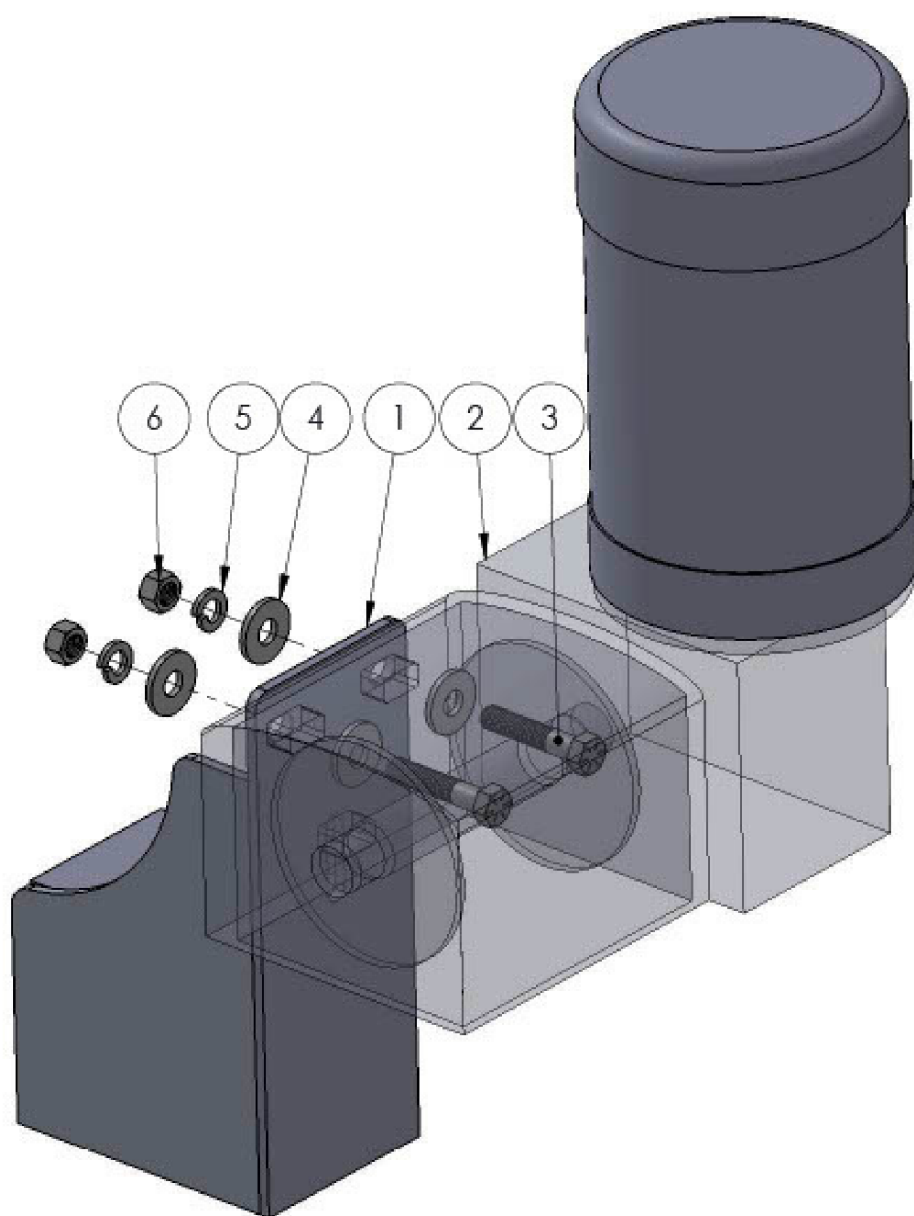



CABLE HOOK-UP

FOR BOTH MANUAL AND ELECTRIC HOIST

PART NO.	MFG. NO.	DESCRIPTION	QTY.
1	M-0154	1/4" X 18' SS CABLE	1
2		1/2"-13 X 2.5" SS BOLT	1
3		1/2" SS CABLE WASHER	2
4		1/2" SS FLATWASHER	1
5		1/2" SS LOCKWASHER	1
6		1/2"-13 SS NUT	1

MANUAL HOIST

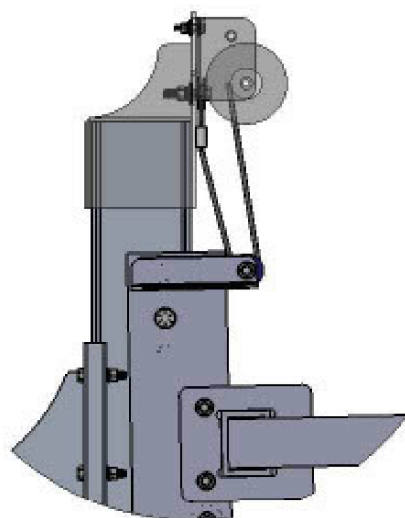
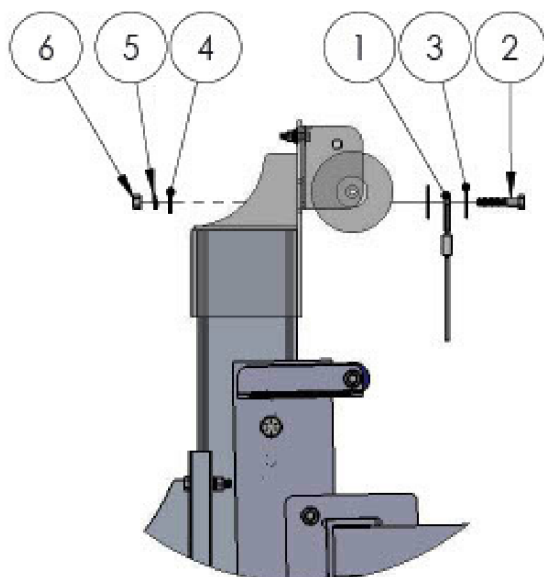

ELECTRIC HOIST

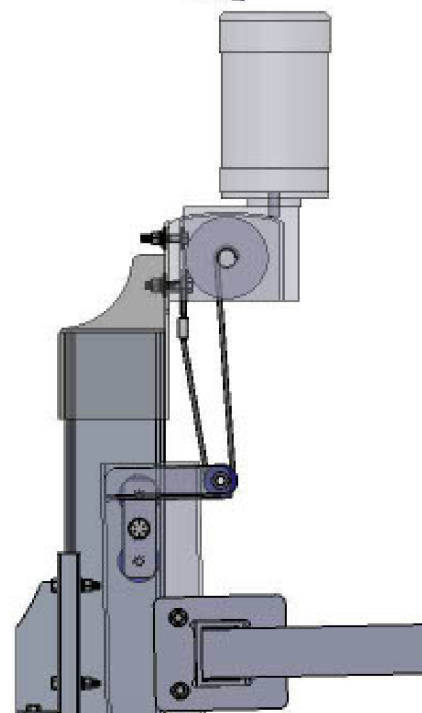
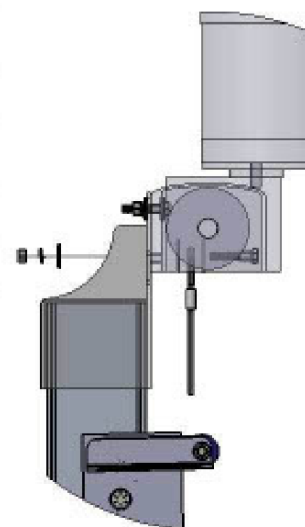



ADJUST STOP BLOCK

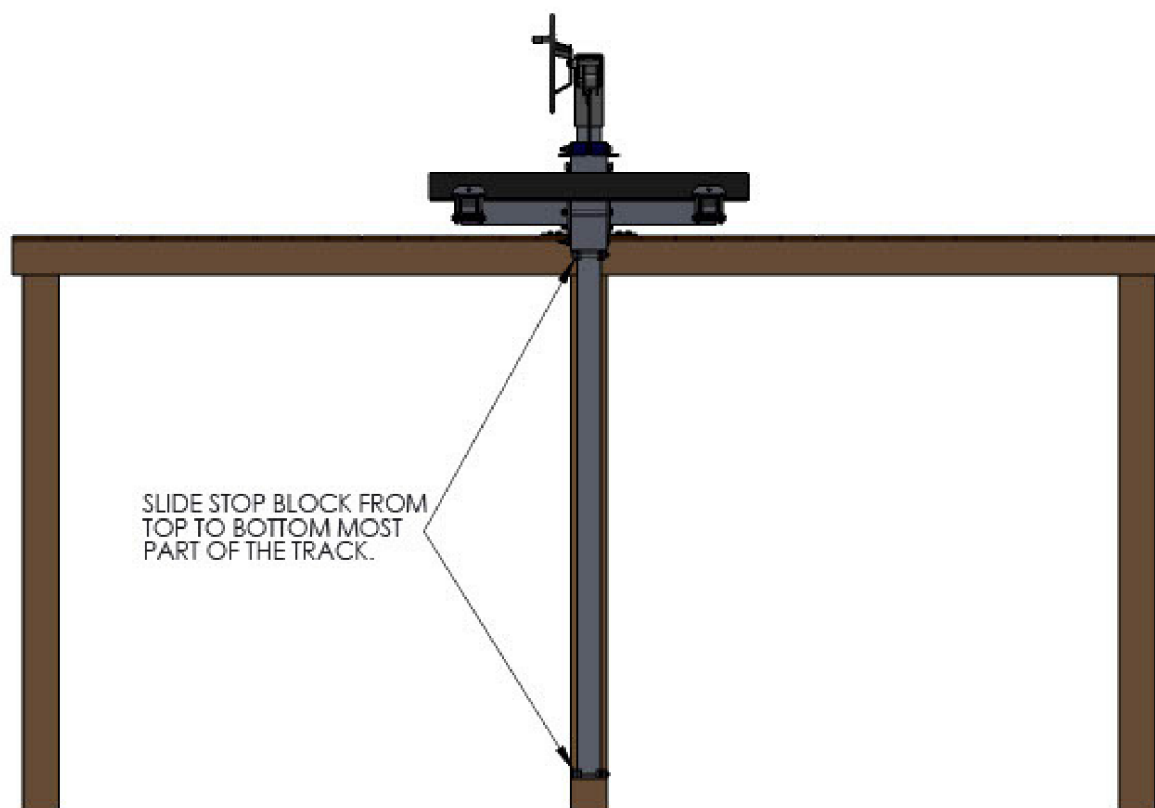

SLIDE STOP BLOCK FROM
TOP TO BOTTOM MOST
PART OF THE TRACK.

NOTE: THIS IS TO KEEP THE CARRIAGE ASSEMBLY
FROM SLIDING OFF THE END OF THE TRACK.