

PolyDock Ladder Connector

Instructions

Part #: 1006674

Parts List			
ITEM	QTY	PART NUMBER	DESCRIPTION
1	1	1005749	Pile Hoop Bracket Top Connector
2	1	1005747	Prt Poly Dock Connector Bottom
3	1	1003822	Weldment QC Poly Dock Ladder Connector Left
4	1	1003823	Weldment QC Poly Dock Ladder Connector Right
--	1	1004581	Bolt Bag QC Poly Dock Ladder Connector
--	2	1004512	Poly Connector Rod 13.875 with hardware (composite)
5	1	1007918	Poly Connector Rod 13.875 Composite
6	1	1001026	Washer Rectangular SS 1/8 x 2 x 3/4
7	1	1002606	Washer Lock 5/16 SS
8	1	1001025	Bolt Hex 5/16-18 x 4.5 Full Thread SS 304
9	1	1002566	Screw Oval #12 x 1.0 SS
10	4	1001956	Bolt Carriage 3/8-16 x 1.0 SS 304
11	4	1001802	Nut Flange 3/8-16 Brass

Failure to follow instructions may result in personal injury and may invalidate the applicable warranty.

Step 1. Insert connecting rods into ladder bottom connector and secure with oval screw.

Step 2. Insert 4-1/2 full thread bolt through lock washer, rectangular washer, and top connector, and thread into connecting rods about 1/2".

Step 3. Assemble ladder (sold separately) according to ladder instructions.

Step 4. Attach ladder to weldment poly dock ladder connectors using 3/8 x 1 carriage bolts and 3/8 flange nuts.

Step 5. Set previously assembled bracket on poly dock in desired position and slide weldment poly dock ladder connectors into slot in ladder bottom connector and tighten 5/16 x 4-1/2 full thread bolts to 20 ft/lbs.

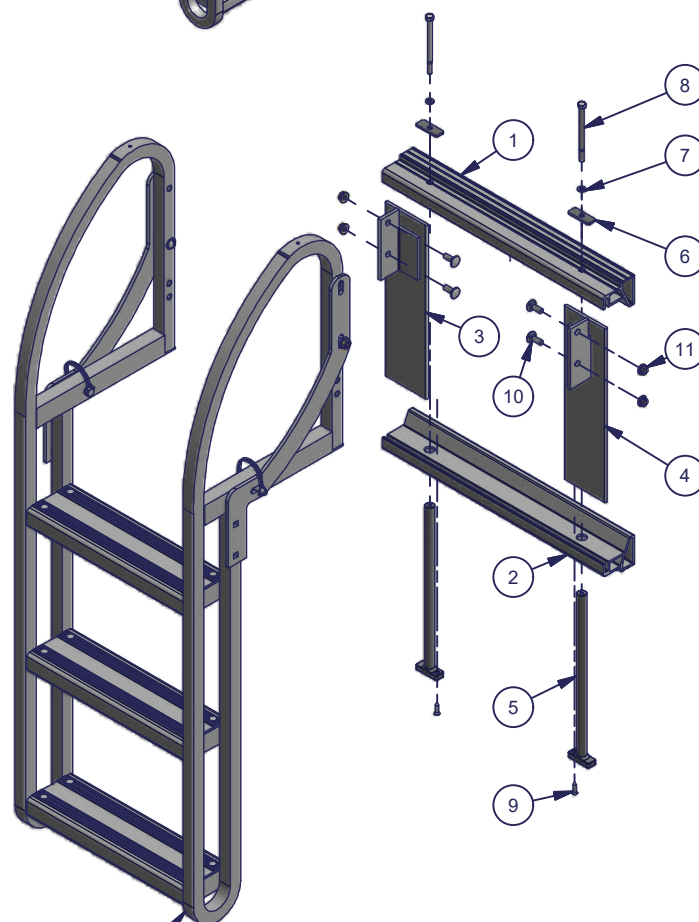
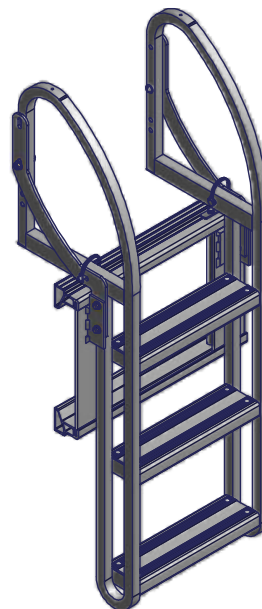

QC Ladder
(sold separately)